

ROCKSILK® FLEXIBLE SLAB ONE HOUR FLOOR UPGRADE LOFT CONVERSIONS INSTALLATION GUIDE

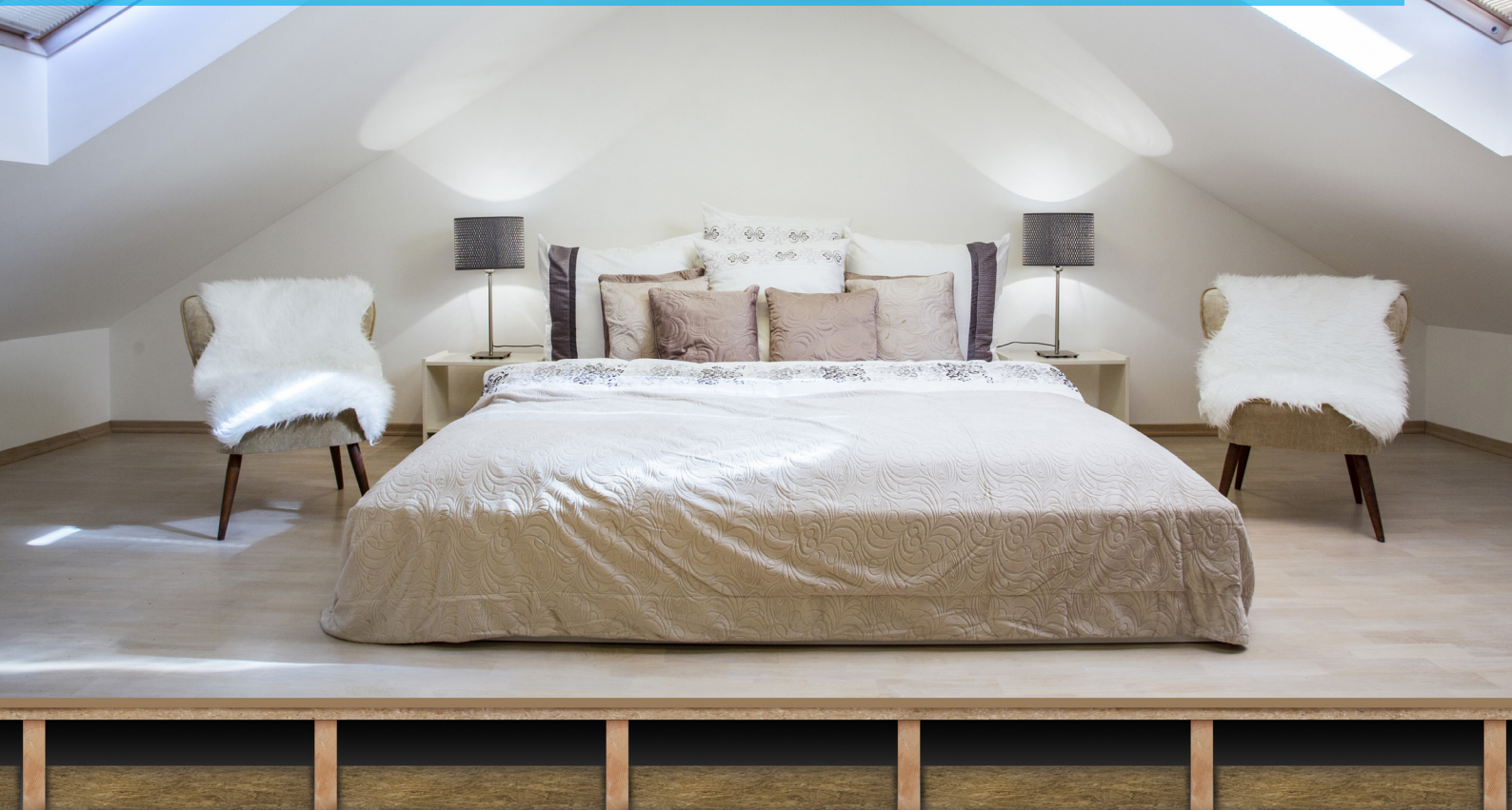

WHAT YOU NEED TO KNOW

CONTENTS

	Page
Safety considerations	3
Typical System	4
Pre-Installation considerations	5
Installation Sequence	6
Cutting	8
Detailing Considerations	9
Fixings	10
Maintenance	11

SAFETY CONSIDERATIONS

STORAGE

Rocksilk® Flexible Slab should be stored properly and handled in such a way as to ensure that it is clean and undamaged.

Rocksilk® Flexible Slab is supplied in PCR (post consumer recycled) polythene packs (4-LDPE) or shrink-wrapped pallets, which are designed for short-term protection only. For longer term protection on site the product should either be stored indoors or under cover and off the ground. Rocksilk® Flexible Slab should not be left permanently exposed to the elements.

If the main hood is removed or damaged, the remaining packs should be kept under cover indoors or protected from the elements by a weatherproof cover. In coastal locations where weather is more extreme and bird damage is more common, use additional covering or store indoors.

The product must be protected from prolonged exposure to sunlight, and stored dry and flat.

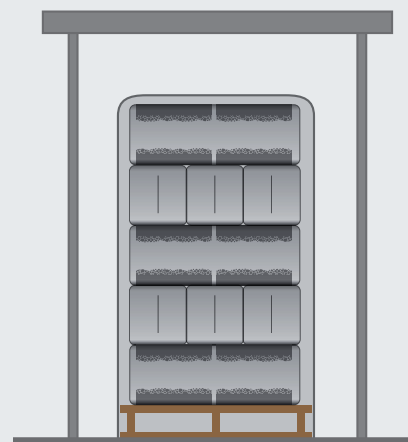

✓ Slabs protected from weathering potential

HANDLING

Rocksilk® Flexible Slab is light and easy to handle; care should be exercised to avoid crushing the edges or corners. If damaged, the product should be discarded. Damaged, contaminated or wet product must not be used.

During construction, exposed areas of slabs should always be covered at the end of a day's work or in heavy rain. Polyethylene covers should be used to provide protection and prevent work from becoming saturated.

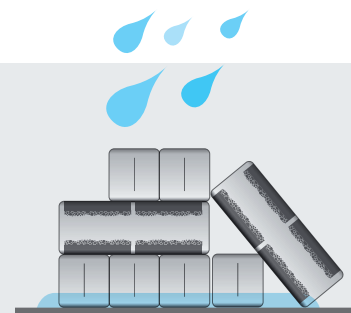

✗ Slabs exposed to the elements

SAFETY EQUIPMENT & TOOLS

It is recommended that the following equipment and tools should be used while handling the product:

Access equipment: Ladder, crawl boards, lighting

PPE: Dust mask (FFP1 minimum), knee pads, gloves, safety glasses

Tools: Knife or fine-toothed saw, tape measure

It is recommended that dust masks, gloves and long-sleeved clothing should be worn during cutting and handling of the product.



TYPICAL CONSTRUCTION

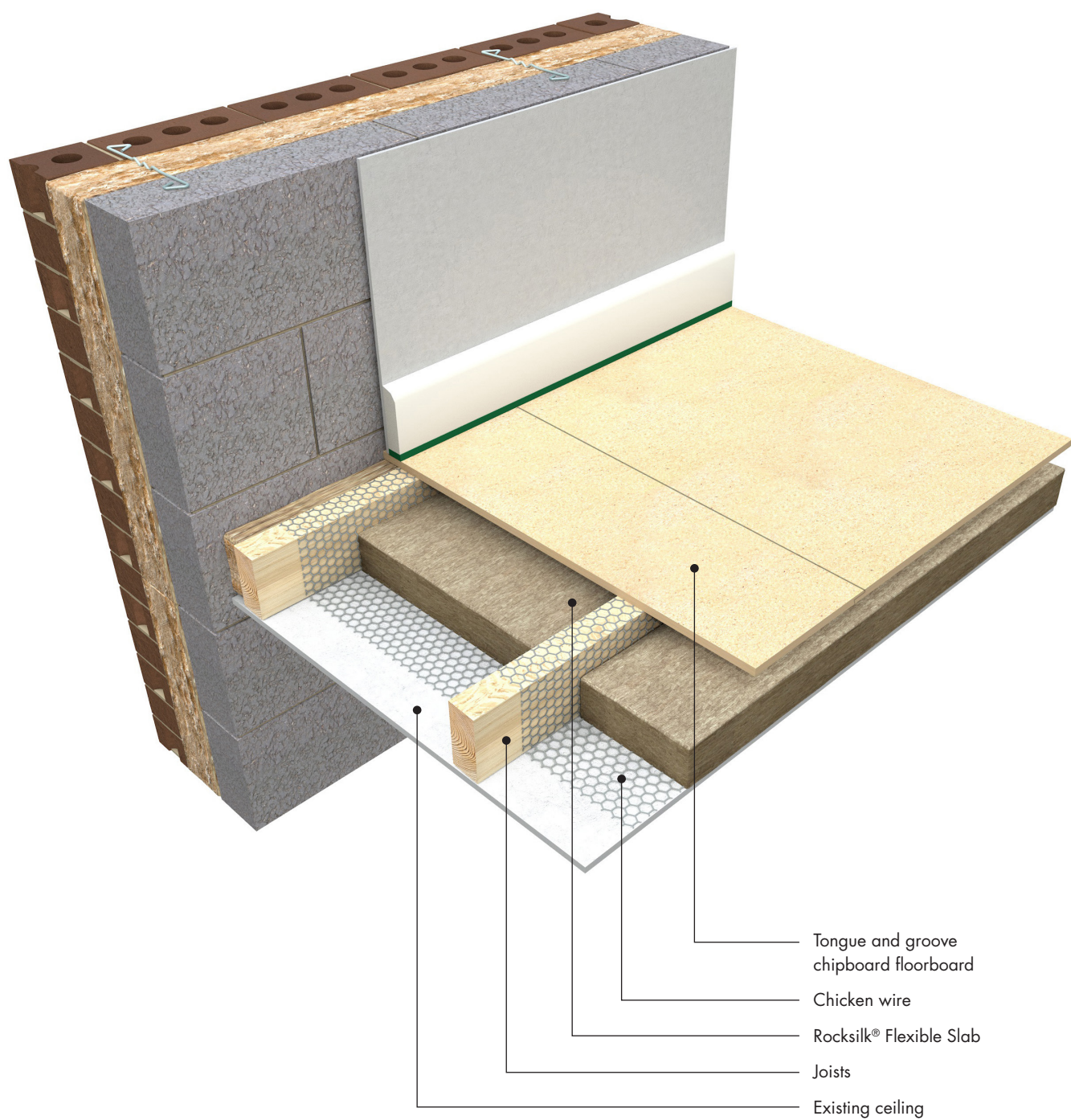

PRE-INSTALLATION CONSIDERATIONS

REVERSIBLE

IT DOESN'T MATTER WHICH WAY ROUND IT IS INSTALLED

Installed with either face in contact with the chicken wire without affecting its durability.

SLABS TO BE IN CONTACT WITH EACH OTHER

Installed such that they are tightly butted together and between joists.



To avoid gaps between the slabs that could compromise the thermal and fire safety performance

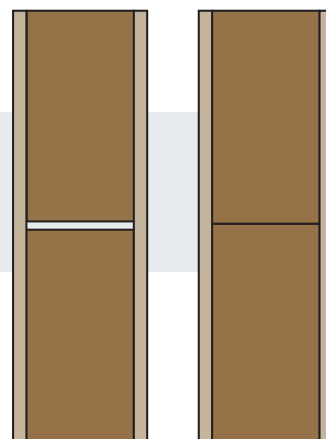

COMPRESSION FIT INTO PLACE

Rocksilk® Flexible Slab should be cut slightly oversize and compression fit into place.



To create a snug fit between slabs, reducing the chance for air gaps



INSTALLATION SEQUENCE

Ensure the voids between the studs are clean and free of debris.

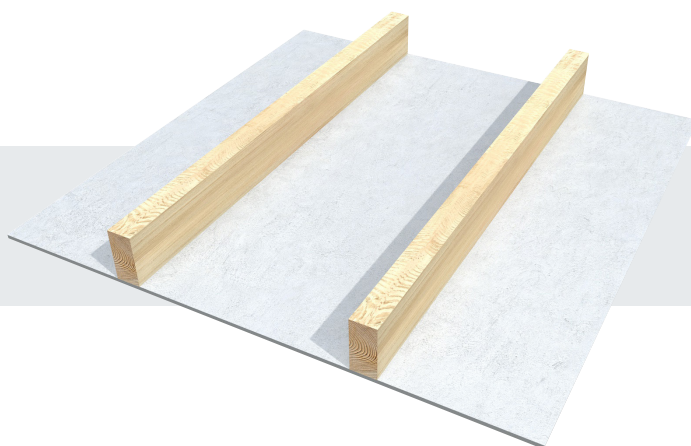

Roll out minimum 0.7mm gauge 25mm chicken wire perpendicular to the joists such that it overlaps the top edges.

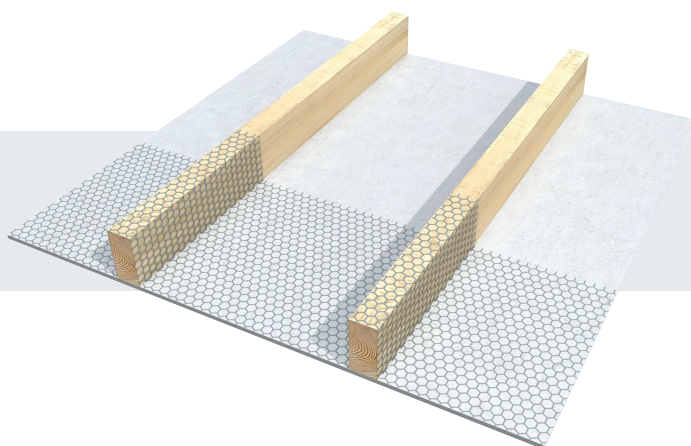

Complete the above process along the full length of the joist. Allow a minimum 50mm overlap of the chicken wire.

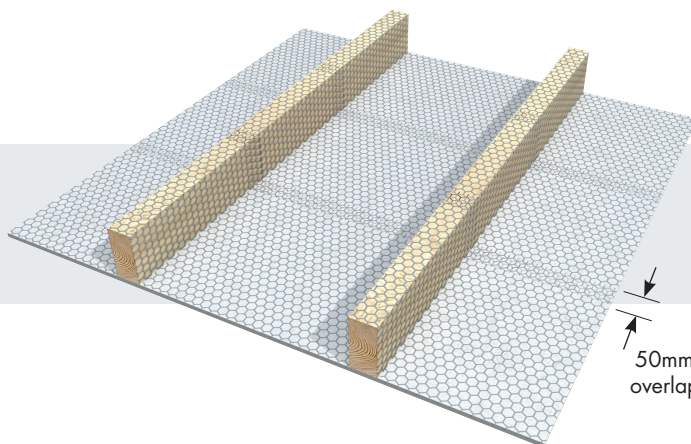

INSTALLATION SEQUENCE

Fix the chicken wire in place 40mm up from the bottom of the joists at 200mm centres using minimum 10mm long staples.

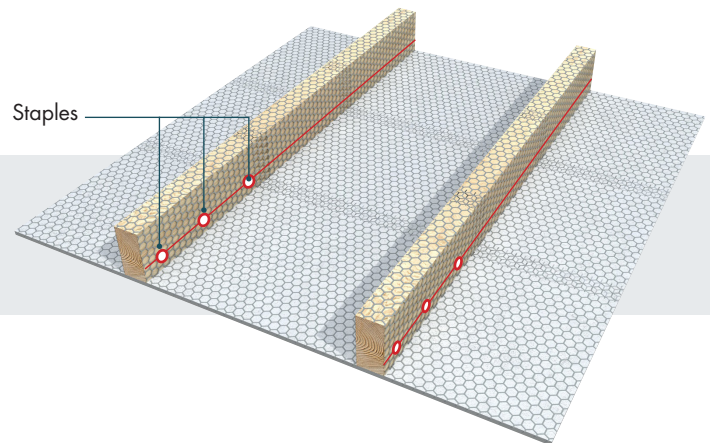

Friction fit Rocksilk® Flexible Slab between the joists, ensuring slabs are cut over size by 5-10mm and compression fit to create a snug fit between joists and the adjoining slabs. Ensure slabs are not cut too large that they bend in the middle, the whole face of the slab should be in contact with the chicken wire.

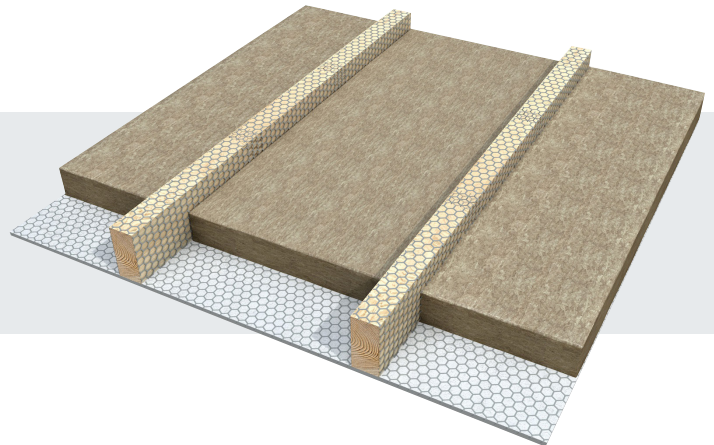

Install minimum 18mm tongue and groove floor boards on top of the joists using nails in accordance with BS8103 or relevant guarantee issuing agency such as NHBC or Premier.

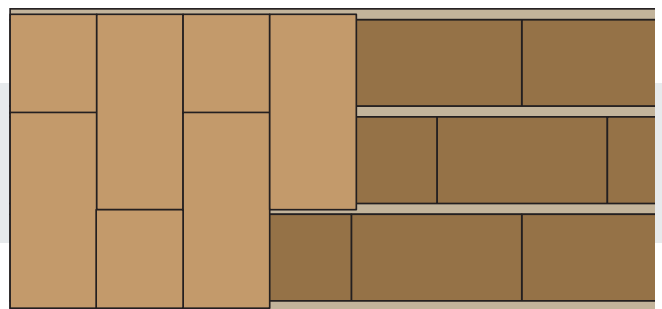

CUTTING

CUT OVERSIZE BY MINIMUM 5MM

Cut slabs oversize by 5-10mm to allow for compression between joists and adjoining slabs.

? To avoid gaps between the slabs that could compromise the fire performance

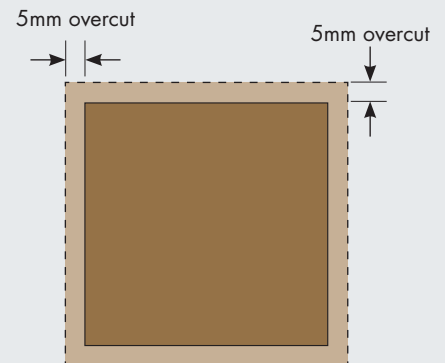

CUT NEATLY WITH A SHARP INSULATION SAW/KNIFE

Cut neatly with a fine serrated saw or a large bladed knife.

? Gives a factory quality cut and prevents tearing

✓ Use insulation saw or knife **✗ Cut using bladed saw**



DETAILING CONSIDERATIONS

COMPLETE PROTECTION

Ensure the chicken wire is formed to create a tight 90° degree angle that sits flush with the bottom of the joist when installed.

This will ensure a good fit of the Rocksilk® Flexible Slab to the joist and provide proper protection to the joist in the event of a fire.

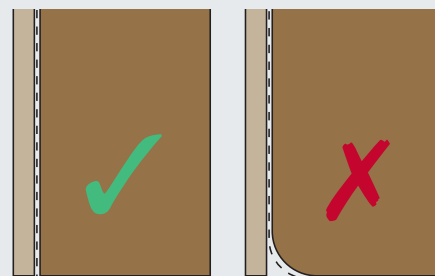

NOGGINS

There is no requirement to return the chicken wire completely up and over horizontal noggins. Ensure the chicken wire is returned at least 40mm up the noggin and secured with staples 40mm from the bottom of the joists.



CORNERS AND FOLDS

On corners and other areas where multiple layers of chicken wire may occur it is recommended to cut away any excess wire such that a neat fit of the chicken wire and Rocksilk® Flexible Slab can be achieved against all sides of the joists and noggins.

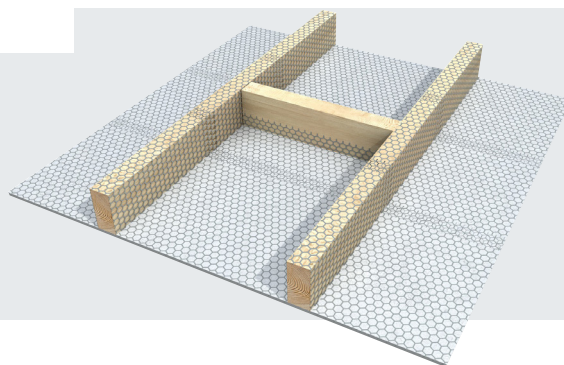

To ensure a snug fit between the joists

FIXINGS

STAPLES

Use minimum 10mm heavy duty staples fixed at 200mm centres at least 40mm from the bottom of the joists.

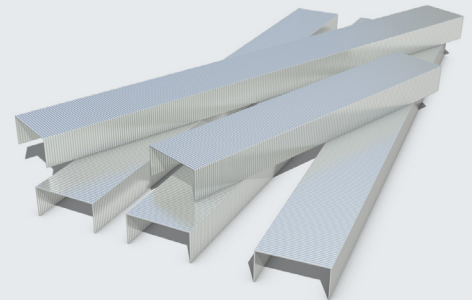

CHICKEN WIRE

Use minimum 0.7mm gauge 25mm chicken wire.

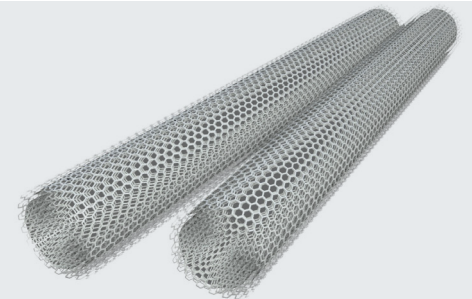

NAILS

Nail or screw the tongue and groove flooring in position ensuring NHBC guidance on fixing positions is followed. Minimum 3mm nails 2.5 x the depth of the chipboard or screws minimum size 8 and 2 x the depth of the chipboard should be used.

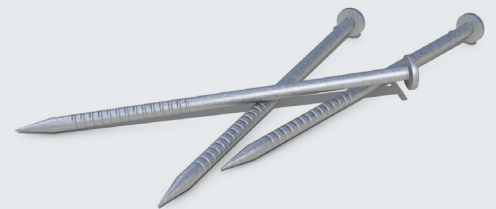

MAINTENANCE

CONSTRUCTION REPAIRS

In the event of small repairs being needed on site, we recommend the replacement of full slabs wherever possible. This reduces the number of joints between the slabs reducing the chances of unwanted air gaps.

? To avoid gaps between the slabs that could compromise the fire performance

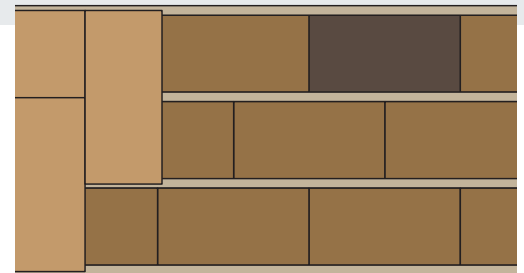
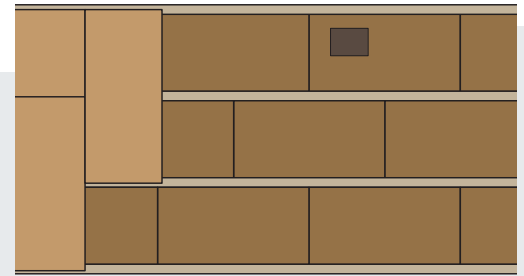

CONTACTS

Technical Support Team

Tel: 01744 766 666

email: technical.uk@knaufinsulation.com



Knauf Insulation Ltd PO Box 10, Stafford Road, St.Helens, Merseyside, WA10 3NS. UK

For more information please visit knaufinsulation.co.uk

All rights reserved, including those of photomechanical reproduction and storage in electronic media. Extreme caution was observed when putting together and processing the information, texts and illustrations in this document. Nevertheless, errors cannot quite be ruled out. The publisher and editors cannot assume legal responsibility or any liability whatever for incorrect information and the consequences thereof. The publisher and editors will be grateful for improvement suggestions and details of possible errors pointed out.

challenge.
create.
care.