

## HOMESEAL LDS FLEXPLUS

[www.knaufinsulation.com](http://www.knaufinsulation.com)

### VARIABLE VAPOUR CONTROL LAYER (VCL)

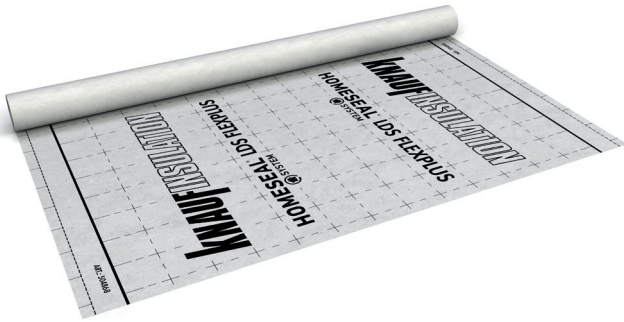

### PRODUCT DESCRIPTION

Reinforced, laminated water-vapour retardant climate membrane made of combination of polyester (PES) with polyamide (PA) layers with a variable Sd value between 0.2 and 20 m depending of the relative humidity, compliant with EN 13984.

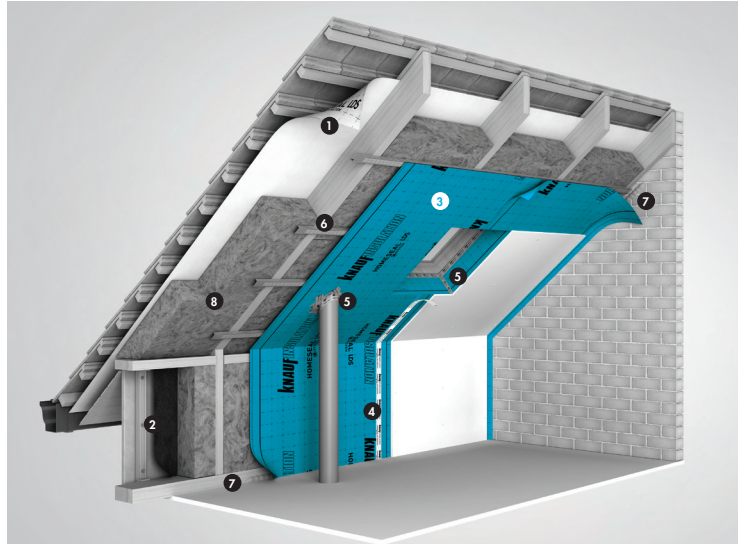

**HOMESEAL<sup>®</sup>**  
SYSTEM

#### Weather membranes

- HOMESEAL LDS 0.02
- 1 HOMESEAL LDS 0.04
- HOMESEAL LDS 0.04 FIXPLUS
- 2 HOMESEAL LDS 0.02 UV
- HOMESEAL LDS 0.02 UV FIXPLUS

#### Vapour control layers

- HOMESEAL LDS 2
- HOMESEAL LDS 5
- HOMESEAL LDS 35
- 3 HOMESEAL LDS 40
- HOMESEAL LDS 100
- HOMESEAL LDS 100 ALUPLUS
- HOMESEAL LDS 200 ALUPLUS
- HOMESEAL LDS FLEXPLUS

#### Tapes and sealants

- 4 HOMESEAL LDS SOLUPLAN
- 5 HOMESEAL LDS SOLIFIT-1
- 6 HOMESEAL LDS SOLIFIT-2
- 7 HOMESEAL LDS SOLIMUR 310

#### Insulation

- 8 KNAUF INSULATION MINERAL WOOL

### SPECIFICATIONS

Water vapor permeability; Sd value (EN ISO 12572)	0.2 – 20 m (EN ISO 12572) 11 m (EN 1931) : Sd at 23°C and 37,5% RH
General Product Standard	EN 13984
Certification	Declaration of Performance
Reaction to fire (EN 13501-1)	E
Resistance to water penetration (EN 1928)	W1
Tensile Strength (EN 12311-1)	159 (L) / 123 (T) N/50mm
Tear resistance (EN 12310-1)	30 (L) / 25 (T) N
Thickness (EN 1849-2)	Approx. 0.14 mm
Hazardous substances	None
Roll width	1.5 m
Roll length	40 m
m <sup>2</sup> /roll	60 m <sup>2</sup>

## HOMESEAL LDS FLEXPLUS

[www.knaufinsulation.com](http://www.knaufinsulation.com)

### ADDITIONAL INFORMATION

#### Applications

For use as a variable humidity vapour barrier as well as for air sealing sheet according ETAG 007 (Guideline for European Technical Approval of timber frame building kits) in combination with the components of the Homeseal LDS system. This is a top-of-the-range smart membrane used for the most stringent pitched roof and external wall applications from the inside.

Note: In case of high humidity levels due to plastering or wet screed work, problems may occur due to the pronounced expansion of the polyamide coating of the vapour barrier sheet. In this case we recommend use of the Knauf Insulation LDS 2 vapour barrier sheet with a fixed Sd value of 2 m.

#### Resistance of the material combinations to ageing

Properly performed adhesions with certified system components are highly resistant to ageing and meet the requirements of ETAG 007.

#### Instructions for use

Please observe the relevant installation guidelines and information provided within the packaging guidance icons. In addition, the relevant standards and recognised rules of technology apply. Homeseal LDS FlexPlus must be installed so that the printed (smooth) side faces the installer. Permanent adhesion is only possible on the printed (smooth) side.

Note for blown-in insulation: In combination with blown-in insulation, Homeseal LDS FlexPlus must be fastened with 8x10 mm staples. The distance between the staples must not exceed 100 mm. In addition, a sub-construction (e.g. 30/50 battens) which is installed with a maximum spacing of 500 mm prior to the insulation being blown in, is required to support Homeseal LDS FlexPlus membrane.

#### Storage

Rolls should be stored on a pallet and protected from direct sunlight, rain and snow. The product does not proceed during correct storage. Pallets or roll not stack during transport or storage.

### APPLICATION GUIDELINES



The building must be ventilated to ensure relative humidity stays below 75% during fitting.



Apply staples at a distance of 10-15 cm



Place Homeseal LDS Solifit-2, 2-sided adhesive tape, before applying the membrane



Place the Homeseal LDS Soliplan, 1-sided adhesive tape, to seal the overlap



Always apply the membrane across the bearing elements



Use some pressure to ensure the proper adhesion of the tape on the membrane



Place the membrane with a 10 cm overlap

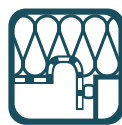

Create airtight connections between Homeseal membranes and construction elements with Homeseal LDS Solimur glue



Use staples size 8/10



Apply Homeseal LDS Solifit-1 tape for closing the gap between ducts and membranes



1301/1396  
15

Knauf Insulation Holding GmbH  
Am Bahnhof 7  
97346 Iphofen  
Germany

EN 13984:2013

Flexible sheet for vapour control  
Homeseal LDS FlexPlus

ABLDFFPCPR  
[dopki.com/ABLDFFP](http://dopki.com/ABLDFFP)

All rights reserved, including those of photomechanical reproduction and storage in electronic media. Extreme caution was observed when putting together and processing the information, texts and illustrations in this document. Nevertheless, errors cannot quite be ruled out. The publisher and editors cannot assume legal responsibility or any liability whatever for incorrect information and the consequences thereof. The publisher and editors will be grateful for improvement suggestions and details of possible errors pointed out.

## ART.: 504868

challenge.  
create.  
care.