

HOMESEAL LDS 0.04

www.knaufinsulation.com

WEATHER MEMBRANE



PRODUCT DESCRIPTION

Extremely robust and easy to install weather membrane made of spunbond polypropylene layers with a polypropylene film with an Sd value of 0.02 m compliant with EN 13859. It is highly windproof, breathable and waterproof.

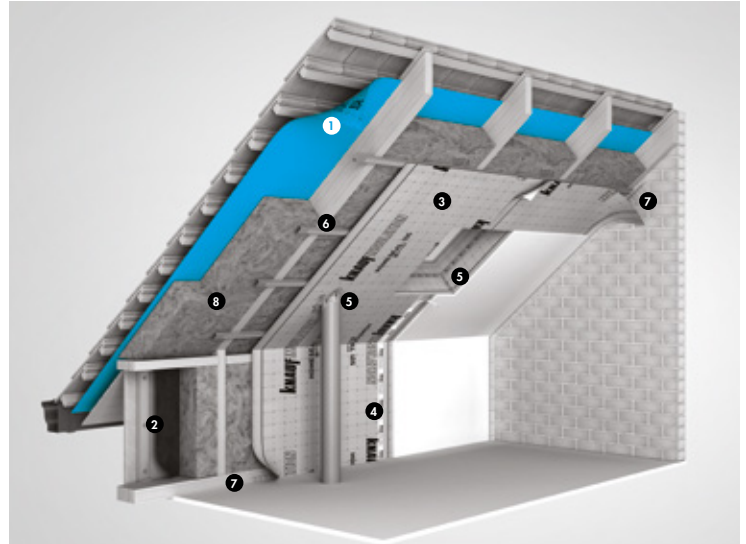

HOMESEAL[®] SYSTEM

Weather membranes

- HOMESEAL LDS 0.02
- 1 HOMESEAL LDS 0.04**
- HOMESEAL LDS 0.04 FIXPLUS
- 2** HOMESEAL LDS 0.02 UV
- HOMESEAL LDS 0.02 UV FIXPLUS

Vapour control layers

- HOMESEAL LDS 2
- HOMESEAL LDS 5
- HOMESEAL LDS 35
- 3** HOMESEAL LDS 40
- HOMESEAL LDS 100
- HOMESEAL LDS 100 ALUPLUS
- HOMESEAL LDS 200 ALUPLUS
- HOMESEAL LDS FLEXPLUS

Tapes and sealants

- 4** HOMESEAL LDS SOLUPLAN
- 5** HOMESEAL LDS SOLIFIT-1
- 6** HOMESEAL LDS SOLIFIT-2
- 7** HOMESEAL LDS SOLIMUR 310

Insulation

- 8** KNAUF INSULATION MINERAL WOOL

SPECIFICATIONS

Water vapor permeability; Sd value (EN 1931)	0.02 m (-0.01/+0.015)
General Product Standard	EN 13859-1, -2
Certification	Declaration of Performance
Reaction to fire (EN 13501-1)	E
Weight per unit area (EN 1849-2)	Approx. 150 g/m ² (±10 g/m ²)
Waterproofing after artificial ageing (EN 13859-1)	W1
Tensile strength before artificial ageing (EN 12311-2)	310 (L) / 215 (T) N/50mm
Tensile strength after artificial ageing (EN 12310-2)	280 (L) / 190 (T) N/50mm
Tear resistance (EN 12310-2)	165 (L) / 190 (T) N
Flexibility at low temperature (EN 1109)	-20°C
Temperature resistance	-40°C to +80°C
Roll width	1.5 m
Roll length	50 m
m ² /roll	75 m ²

HOMESEAL LDS 0.04

www.knaufinsulation.com

ADDITIONAL INFORMATION

Applications

Breathable waterproof roofing weather membrane for pitched supported or unsupported roof construction without sarking. It can also be used for vertical wall construction (non UV-resistant) as wind barrier. It can be applied in direct contact with thermal insulation with recommended overlap.

Resistance of the material combinations to ageing

Properly performed adhesions with certified system components are highly resistant to ageing.

Instructions for use

Please observe the relevant installation guidelines and information provided within the packaging guidance icons. In addition, the relevant standards and recognised rules of technology apply.

Storage

Rolls should be stored on a pallet and protected from direct sunlight, rain and snow. Do not stack pallets or rolls during transport or storage.

APPLICATION GUIDELINES



Place the one-sided adhesive tape to seal the overlap



Create airtight connections between Homeseal membranes and construction elements with Homeseal LDS Solimur sealant



Apply Homeseal LDS Solifit-1 tape for closing the gap between ducts and membranes

CE

1390
15

Knauf Insulation Holding GmbH
Am Bahnhof 7
97346 Iphofen
Germany

EN 13859 -1,-2 : 2014

Flexible sheet for underlays for roof
Homeseal LDS 0.04

ABL004CPR
dopki.com/ABL004

All rights reserved, including those of photomechanical reproduction and storage in electronic media. Extreme caution was observed when putting together and processing the information, texts and illustrations in this document. Nevertheless, errors cannot quite be ruled out. The publisher and editors cannot assume legal responsibility or any liability whatever for incorrect information and the consequences thereof. The publisher and editors will be grateful for improvement suggestions and details of possible errors pointed out.

ART.: 504863

challenge.
create.
care.