

HOMESEAL LDS 100

www.knaufinsulation.com

VAPOUR CONTROL LAYER (VCL)



PRODUCT DESCRIPTION

Vapour control membrane made of low-density polyethylene (LDPE) sheet with a Sd value of 100 m, compliant with EN 13984.

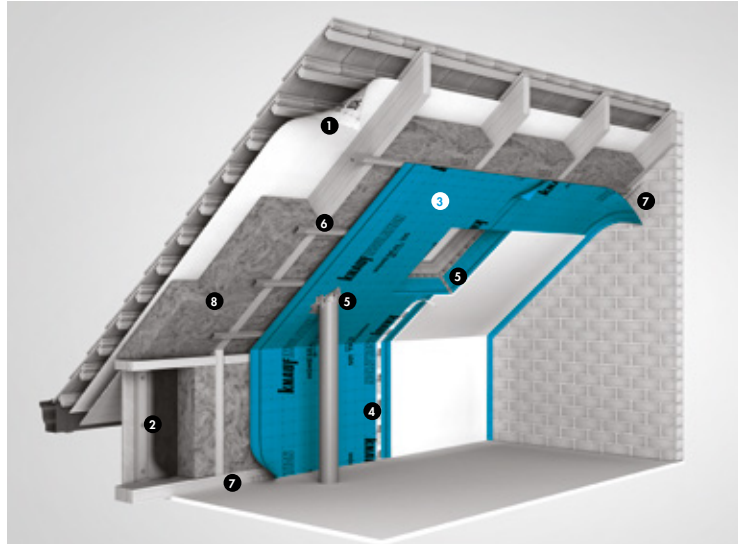

HOMESEAL[®] SYSTEM

Weather membranes

- HOMESEAL LDS 0.02
- ① HOMESEAL LDS 0.04
- HOMESEAL LDS 0.04 FIXPLUS
- ② HOMESEAL LDS 0.02 UV
- HOMESEAL LDS 0.02 UV FIXPLUS

Vapour control layers

- HOMESEAL LDS 2
- HOMESEAL LDS 5
- HOMESEAL LDS 35
- HOMESEAL LDS 40
- ③ HOMESEAL LDS 100
- HOMESEAL LDS 100 ALUPLUS
- HOMESEAL LDS 200 ALUPLUS
- HOMESEAL LDS FLEXPLUS

Tapes and sealants

- ④ HOMESEAL LDS SOLUPLAN
- ⑤ HOMESEAL LDS SOLIFIT-1
- ⑥ HOMESEAL LDS SOLIFIT-2
- ⑦ HOMESEAL LDS SOLIMUR 310

Insulation

- ⑧ KNAUF INSULATION MINERAL WOOL

SPECIFICATIONS

Water vapor permeability; Sd value (EN ISO 1931)	100 m (-0/+20 m)
General Product Standard	EN 13984
Certification	Declaration of Performance
Weight per unit area (EN 1849-2)	Approx. 172 g/m ² (± 7 g/m ²)
Thickness (EN 1849-2)	185 µm
Reaction to fire (EN 13501-1)	E
Water tightness (EN 1928)	Pass
Tensile Strength (EN 12311-2)	160 (L) / 140 (T) N/50 mm
Tear resistance (EN 12310-1)	110 (L) / 110 (T) N
Durability (EN 1296)	Pass
Roll width	2 m
Roll length	50 m
m ² /roll	100 m ²

HOMESEAL LDS 100

www.knaufinsulation.com

ADDITIONAL INFORMATION

Applications

For use as a vapour control layer and air tight membrane in timber frame construction. Designed to be used in combination with the components of the Homeseal system. Recommended solution for pitched roofs and external wall applications from the inside. It is commonly used with drywall and within roof construction.

Resistance of the material combinations to ageing

Properly performed adhesions with certified system components are highly resistant to ageing and meet the requirements of ETAG 007 (Guideline for European Technical Approval of timber building kits).

Instructions for use

Please observe the relevant installation guidelines and information provided within the packaging guidance icons. In addition, the relevant standards and recognised rules of technology apply.

Storage

Rolls should be stored on a pallet and protected from direct sunlight, rain and snow. The product does not proceed during correct storage. Do not stack pallets or rolls during transport or storage.

APPLICATION GUIDELINES



The building must be ventilated to ensure relative humidity stays below 75% during fitting.



Apply staples at a distance of 10-15 cm



Place Homeseal LDS Solifit-2, 2-sided adhesive tape, before applying the membrane



Place the Homeseal LDS Soliplan, 1-sided adhesive tape, to seal the overlap



Always apply the membrane across the bearing elements



Use some pressure to ensure the proper adhesion of the tape on the membrane



Place the membrane with a 10 cm overlap



Create airtight connections between Homeseal membranes and construction elements with Homeseal LDS Solimur glue



Use staples size 8/10



Apply Homeseal LDS Solifit-1 tape for closing the gap between ducts and membranes

CE

761
15

Knauf Insulation Holding GmbH
Am Bahnhof 7
97346 Iphofen
Germany

EN 13984:2013

Flexible sheet for vapour control
Homeseal LDS 100

ABL100CPR
dopki.com/ABL100

All rights reserved, including those of photomechanical reproduction and storage in electronic media. Extreme caution was observed when putting together and processing the information, texts and illustrations in this document. Nevertheless, errors cannot quite be ruled out. The publisher and editors cannot assume legal responsibility or any liability whatever for incorrect information and the consequences thereof. The publisher and editors will be grateful for improvement suggestions and details of possible errors pointed out.

ART.: 504865

challenge.
create.
care.