

Thermal



The energy saving properties and thermal performance of Rock Mineral Wool keep buildings warm in winter and cool in summer.

Our Earthwool® Building and Flexible Slabs help maintain a stable inside temperature by slowing heat transfer by convection, conduction and radiation.

Fire Safety



The fire performance of Rock Mineral Wool gives the ability to provide passive fire protection. Buildings must be designed to minimise the risk of fire and its spread should it occur.

As well as acting as a barrier to the fire, should it occur, our non-combustible Earthwool® Building and Flexible Slabs will not add to its development stages, minimising its overall effect and consequences.

Acoustic



The acoustic performance of Rock Mineral Wool can help create an improved internal environment for building occupants.

Earthwool® Building and Flexible Slabs provide high levels of sound absorption and noise reduction, in new build or within existing buildings through retrofit, to provide improved sound insulation and acoustic comfort.

EARTHWOOL® BUILDING SLABS



with ECOSE® TECHNOLOGY

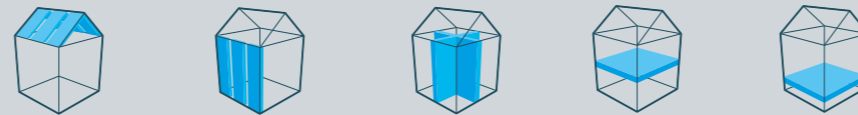

BENEFITS

- ✓ Excellent thermal performance.
- ✓ Non-combustible A1 Euroclass Reaction to Fire classification.
- ✓ Excellent sound absorption characteristics provide high levels of sound reduction.
- ✓ Multi-purpose product range which can be used to insulate a wide range of applications on site.

EARTHWOOL® FLEXIBLE SLABS



with ECOSE® TECHNOLOGY

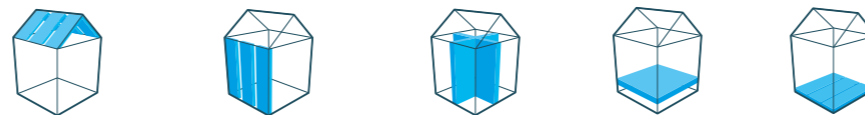

BENEFITS

- ✓ Excellent thermal performance.
- ✓ Non-combustible A1 Euroclass Reaction to Fire classification.
- ✓ Excellent sound absorption characteristics provide high levels of sound reduction.
- ✓ Multi-purpose product which can be used to insulate a wide range of applications on site.
- ✓ Flexible on all four sides for quick and simple installation.



ONE HOUR FLOOR UPGRADE

Where the loft of a two story house is converted into habitable accommodation, the floor to the new rooms must have 30 minutes fire resistance.

Earthwool® Flexible Slab has been tested to achieve **60** minutes fire resistance.

KNAUF INSULATION

FLEXIBLE ROCK SOLUTIONS FOR BUILDINGS

PROVEN PERFORMANCE WITH ECOSE® TECHNOLOGY

ECOSE® Technology is our revolutionary, sustainable bio-based binder used in the manufacture of Earthwool® Building and Flexible Slabs.

KEY BENEFITS

A NATURAL BINDER: ECOSE® Technology contains no added phenol or formaldehyde. Natural raw materials replace the chemicals used in traditional binders.

LOWER EMBODIED ENERGY: Products manufactured using ECOSE® Technology are 70% less energy-intensive when compared to mineral wool products made using traditional formaldehyde-based binders, reducing the ecological footprint.

PROVEN DURABILITY: The exceptional strength of our bio-based binder makes products manufactured with ECOSE® Technology highly durable.

EASY HANDLING: Softer texture to the touch and easier to handle compared to products made with chemical-based binder.

FLEXIBLE ROCK SOLUTIONS FOR BUILDINGS

Earthwool® Building and Flexible Slabs



For illustrative purposes only

Pitched roof rafter level

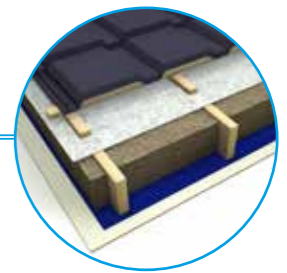

Loft conversion floor

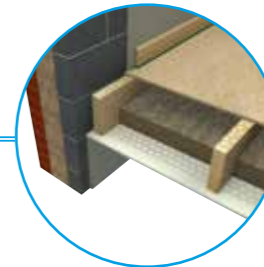

Partitions

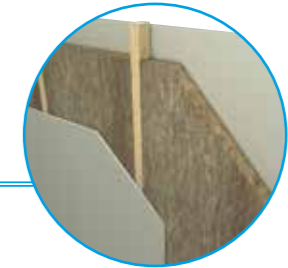

Timber frame walls

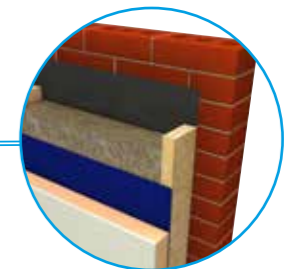

Internal floors

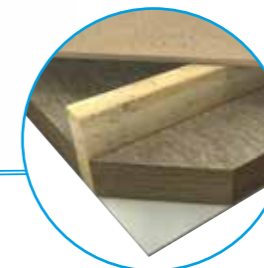

Ground floors (suspended timber)

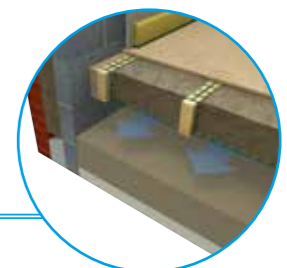

Application	Earthwool® Flexible Slab	Earthwool® Building Slab
Pitched roof rafters	✓	✓
Intermediate and internal floors	✓	✓
One hour floor upgrade	✓	-
Internal walls and partitions	✓	✓
External timber frame walls	✓	✓
Ground floors (suspended timber)	✓	✓
Light steel frame walls	✓	✓
Fabrication	✓	✓

- ✓ Suitable product
- ✓ Optimum product

CERTIFICATION

Our Rock Mineral Wool products made using ECOSE® Technology have the best possible Eurofins Gold Certificate for Indoor Air Comfort. Contributing to a high level of indoor air quality and providing a strong endorsement of the enhanced environmental performance of our product range.

Earthwool® Building Slab RS45 and Flexible Slab both have the best possible non-combustible A1 Euroclass Reaction to Fire classifications, meaning they will not contribute in any stage of the fire, including the fully developed fire.



challenge.
create.
care.